

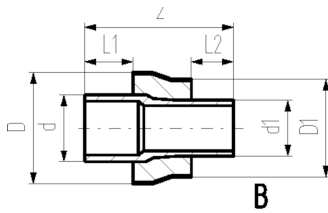

COOL-FIT PE Plus reducer, PE100
Insulated d32-d225
Metric, SDR11

Model:

- Insulation made from PUR foam
- Outer jacket impact and UV resistant. Color: Black
- Electrofusion Fitting with integrated sealing lip, for a water and vapor tight seal
- Type B: Spigot Fitting with free ends

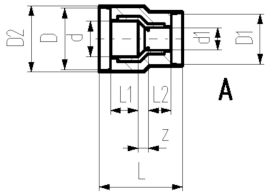

d (mm)	D (mm)	d1 (mm)	D1 (mm)	Code	weight (lb)	D2 (mm)	L (mm)	L1 (mm)	L2 (mm)	z (mm)	closest inch (inch)	Type
40	110	32	90	738 903 206	0.551	117	143	40	36	17	1 ¼	A
50	110	32	90	738 903 209	0.617	117	151	44	36	21	1 ½	A
50	110	40	110	738 903 210	0.705	117	149	44	40	15	1 ½	A
63	125	32	90	738 903 212	0.478	132	160	48	36	26	2	A
63	125	40	110	738 903 213	0.511	132	159	48	40	21	2	A
63	125	50	110	738 903 214	0.536	132	159	48	44	17	2	A
75	140	63	125	738 903 318	0.582			55	48	170	2 ½	B
90	160	63	125	738 903 322	0.853			62	48	190	3	B
90	160	75	140	738 903 323	0.917			62	55	189	3	B
110	180	63	125	738 903 327	1.248			72	48	204	4	B
110	180	75	140	738 903 328	1.272			72	55	205	4	B
110	180	90	160	738 903 329	1.420			72	62	205	4	B
140	225	63	125	738 903 340	2.465			84	48	225	5	B
140	225	75	140	738 903 341	2.650			84	55	237	5	B
140	225	90	160	738 903 342	2.758			84	62	238	5	B
140	225	110	180	738 903 343	2.802			84	72	233	5	B
160	250	63	125	738 903 347	2.862			90	48	244	6	B
160	250	90	160	738 903 349	2.917			90	62	244	6	B
160	250	110	180	738 903 350	3.003			90	72	242	6	B
160	250	140	225	738 903 351	4.068			90	84	257	6	B
160	250	140	200	738 904 351	3.668			90	84	257	6	B
225	315	63	125	738 903 364	6.526			110	48	295	8	B
225	315	90	160	738 903 366	6.654			110	62	295	8	B
225	315	110	180	738 903 367	6.788			110	72	295	8	B
225	315	140	225	738 903 368	7.591			110	84	296	8	B
225	315	140	200	738 904 368	6.993			110	84	296	8	B
225	315	160	250	738 903 369	7.826			110	90	279	8	B

The technical data are not binding. They neither constitute expressly warranted characteristics nor guaranteed properties nor a guaranteed durability. They are subject to modification. Our General Terms of Sale apply.

Georg Fischer Piping Systems Ltd, Postfach, CH-8201 Schaffhausen/Switzerland Phone +41 -(0)52-631 1111 e-mail:
 info.ps@georgfischer.com Internet: <http://www.gfps.com>