

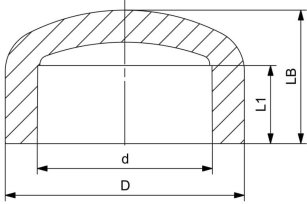

## AQUASYSTEM End Cap PP-R

Dim. (mm)	Code	GP	SP	PN (bar)	D (mm)	d (mm)	L1 (mm)	LB (mm)
20	<b>4302902006021</b>	1000	100	25	28.0	19.2	14.5	22.5
25	<b>4302902506121</b>	600	100	25	33.5	24.2	17.0	26.5
32	<b>4302903206221</b>	300	50	25	42.0	31.1	19.0	30.3
40	<b>4302904006321</b>	175	25	25	52.0	39.0	20.5	39.0
50	<b>4302905006421</b>	100	10	25	65.0	48.9	23.5	45.4
63	<b>4302906306521</b>	50	10	25	83.0	61.9	28.0	44.9
75	<b>4302907506621</b>	25	5	25	99.0	73.4	31.0	50.7
90	<b>4302909006821</b>	18	3	25	119.4	90.0	35.5	59.8
110	<b>4302911006721</b>	9	3	25	143.8	108.0	41.5	69.9



The technical data are not binding. They neither constitute expressly warranted characteristics nor guaranteed properties nor a guaranteed durability. They are subject to modification. Our General Terms of Sale apply.

Georg Fischer Piping Systems Ltd, Postfach, CH-8201 Schaffhausen/Switzerland

Phone +41 -(0)52-631 1111

e-mail: [info.ps@georgfischer.com](mailto:info.ps@georgfischer.com)

Internet: <http://www.gfps.com>