

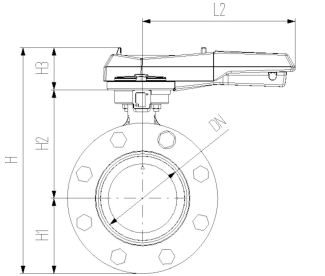

**COOL-FIT 2.0 Wafer-style butterfly valve kit type 567**  
**Hand lever with ratchet settings**

**Model:**

- Material: PVC-U with spigot PE100 SDR11, metric
- Including valve, flange adaptors, and insulation half shells



d (mm)	DN (mm)	PN	Cv-value (l/min)	EPDM Code	weight (kg)
110	100	10	6500	<b>138 567 314</b>	3.500
140	125	10	11500	<b>138 567 316</b>	4.500

d (mm)	DN (mm)	D (mm)	D1 (mm)	D2 (mm)	L (mm)	L1 (mm)	L2 (mm)	L3 (mm)	z (mm)	z1 (mm)	z2 (mm)	H (mm)	H1 (mm)	H2 (mm)	H3 (mm)
110	100	260	188	168	552	72	255	106	696	320	56	325	104	167	55
140	125	287	233	208	662	84	255	106	830	383	64	352	117	181	55

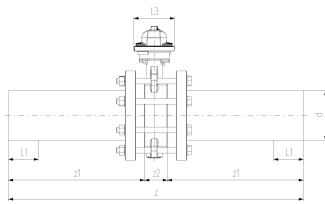

d (mm)	DN (mm)	closest inch (inch)
110	100	4
140	125	5

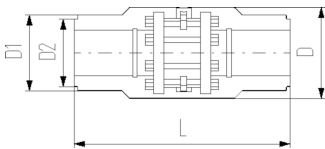

The technical data are not binding. They neither constitute expressly warranted characteristics nor guaranteed properties nor a guaranteed durability. They are subject to modification. Our General Terms of Sale apply.

Georg Fischer Piping Systems Ltd, Postfach, CH-8201 Schaffhausen/Switzerland Phone +41 -(0)52-631 1111 e-mail: info.ps@georgfischer.com Internet: <http://www.gfps.com>