

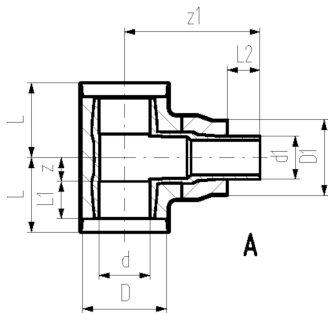

A



B



A

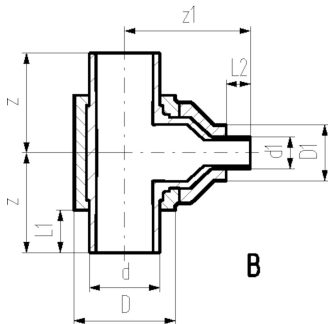

B

COOL-FIT 2.0 Tee 90° reduced

Model:

- Pre-insulated PE100 SDR11, metric
- Insulation made from PUR foam
- Outer jacket impact and UV resistant. Color: Black
- A: Electrofusion Fitting with integrated sealing lip, for a moisture-proof and vapour tight sealing. Branch with free pipe end.
- Type B: Spigot fitting with free ends (Electrofusion Coupler needed for joining)

DN (mm)	d/D (mm)	SDR	d1/D1 (mm)	PN (bar)	Code	weight (kg)
65	75/125	11	63/110	16	738 204 218	0.746
80	90/140	11	63/110	16	738 204 222	1.096
80	90/140	11	75/125	16	738 204 223	1.133
100	110/160	11	63/110	16	738 204 227	1.746
100	110/160	11	75/125	16	738 204 228	1.782
100	110/160	11	90/140	16	738 204 229	1.848
125	140/200	11	63/110	16	738 204 340	3.441
125	140/200	11	75/125	16	738 204 341	3.504
125	140/200	11	90/140	16	738 204 342	3.569
125	140/200	11	110/160	16	738 204 343	3.620

L (mm)	L1 (mm)	L2 (mm)	z (mm)	z1 (mm)	closest inch (inch)	Type
110	55	48	36	200	2 ½ - 2	A
124	62	48	42	227	3 - 2	A
124	62	55	42	227	3 - 2 ½	A
148	72	48	57	245	4 - 2	A
148	72	55	57	245	4 - 2 ½	A
148	72	62	57	245	4 - 3	A
	84	48	198	250	5 - 2	B
	84	55	198	262	5 - 2 ½	B
	84	62	198	263	5 - 3	B
	84	72	198	258	5 - 4	B

The technical data are not binding. They neither constitute expressly warranted characteristics nor guaranteed properties nor a guaranteed durability. They are subject to modification. Our General Terms of Sale apply.

Georg Fischer Piping Systems Ltd, Postfach, CH-8201 Schaffhausen/Switzerland Phone +41 -(0)52-631 1111 e-mail: info.ps@georgfischer.com Internet: <http://www.gfps.com>