

COOL-FIT 2.0 Tee 90° equal

Model:

- Pre-insulated PE100 SDR11, metric
- Insulation made from PUR foam
- Outer jacket impact and UV resistant. Color: Black
- A: Electrofusion Fitting with integrated sealing lip, for a moisture-proof and vapour tight sealing
- Type B: Spigot fitting with free ends (Electrofusion Coupler needed for joining)



A



B

d/D (mm)	DN (mm)	SDR	PN (bar)	Code	weight (kg)	L (mm)	L1 (mm)	z (mm)	z1 (mm)	closest inch (inch)	Type
32/75	25	11	16	738 204 108	0.154	73	36	18	98	1	A
40/90	32	11	16	738 204 109	0.230	81	40	22	112	1 ¼	A
50/90	40	11	16	738 204 110	0.306	88	44	25	125	1 ½	A
63/110	50	11	16	738 204 111	0.492	97	48	30	147	2	A
75/125	65	11	16	738 204 112	0.673	110	55	36	140	2 ½	A
90/140	80	11	16	738 204 113	1.022	124	62	43	161	3	A
110/160	100	11	16	738 204 114	1.751	148	72	57	184	4	A
140/200	125	11	16	738 204 116	3.317		84	198	193	5	B

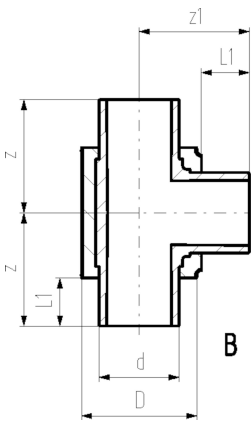
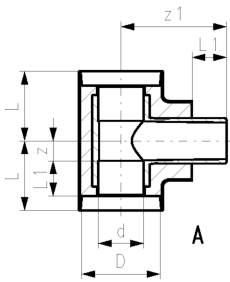

The technical data are not binding. They neither constitute expressly warranted characteristics nor guaranteed properties nor a guaranteed durability. They are subject to modification. Our General Terms of Sale apply.

Georg Fischer Piping Systems Ltd, Postfach, CH-8201 Schaffhausen/Switzerland Phone +41 -(0)52-631 1111 e-mail: info.ps@georgfischer.com Internet: <http://www.gfps.com>