

## COOL-FIT 2.0 Elbow 45°

### Model:

- Pre-insulated PE100 **SDR11**, metric
- Insulation made from PUR foam
- Outer jacket impact and UV resistant. Color: Black
- A: Electrofusion Fitting with integrated sealing lip, for a moisture-proof and vapour tight sealing
- Type B: Spigot fitting with free ends (Electrofusion Coupler needed for joining)



A



B

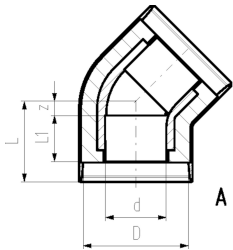

A

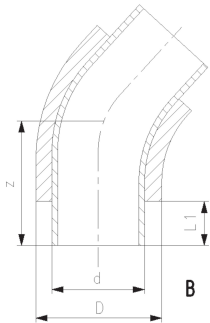

B

d/D (mm)	DN (mm)	SDR	PN (bar)	Code	weight (kg)	L (mm)	L1 (mm)	z (mm)	closest inch (inch)	Type
32/75	25	11	16	<b>738 154 108</b>	0.101	66	36	11	1	A
40/90	32	11	16	<b>738 154 109</b>	0.143	70	40	11	1 ¼	A
50/90	40	11	16	<b>738 154 110</b>	0.206	76	44	13	1 ½	A
63/110	50	11	16	<b>738 154 111</b>	0.307	83	48	16	2	A
75/125	65	11	16	<b>738 154 112</b>	0.407	92	55	18	2 ½	A
90/140	80	11	16	<b>738 154 113</b>	0.686	111	62	30	3	A
110/160	90	11	16	<b>738 154 114</b>	1.123	132	72	41	4	A
140/200	125	11	16	<b>738 154 116</b>	1.967		84	164	5	B

The technical data are not binding. They neither constitute expressly warranted characteristics nor guaranteed properties nor a guaranteed durability. They are subject to modification. Our General Terms of Sale apply.

Georg Fischer Piping Systems Ltd, Postfach, CH-8201 Schaffhausen/Switzerland Phone +41 -(0)52-631 1111 e-mail: info.ps@georgfischer.com Internet: <http://www.gfps.com>