



**Lug-Style, end installation butterfly valve metal type 038**  
**With hand lever**  
**Flange standard metric - PN10**  
**Disc: ductile iron/Rilsan® coated**

**Model:**

- Lug Style
- Body GGG40 (A 395 / A395 M-99, EN-JIS 1020 EN1563) Rilsan® coating
- Body from DN350 Epoxy® coating
- Installation length: EN 558 row 20
- Interface according to DIN EN ISO 5211
- Pressure range: 16 bar (DN 50-300); 10 bar (DN 350-600)
- Single-piece axis with square profile, up to DN 600 mm 2-pieces axis
- Multiple flange connection: DIN PN 6/10/16; other standard e.g. ANSI/ASME B16.5 Class 150 on request

**Option:**

- Electric and pneumatic actuator on request
- Other liner material on request

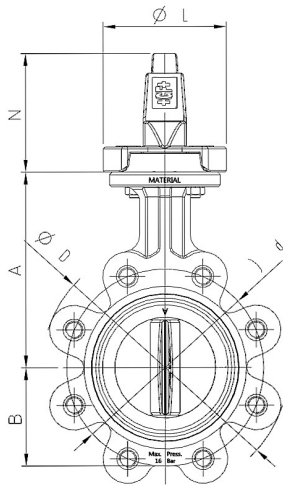

d (mm)	DN (mm)	Size (inch)	PN (bar)	Cv-value (l/min)
63	50	2	16	3140
75	65	2 ½	16	4570
90	80	3	16	7140
110	100	4	16	11710
140	125	5	16	18570
160	150	6	16	27130
225	200	8	16	47130
280	250	10	16	77110
315	300	12	16	114240

d (mm)	Liner: EPDM Code	Liner: FKM Code	Liner: EPDM DVGW Code	Liner: NBR Code	SP	weight (kg)	PF
63	199 038 000	199 038 013	199 038 181	199 038 160	1	3.90	3 39 226 101
75	199 038 001	199 038 014	199 038 182	199 038 161	1	5.00	3 39 226 101
90	199 038 002	199 038 015	199 038 183	199 038 162	1	6.70	3 39 226 101
110	199 038 003	199 038 016	199 038 184	199 038 163	1	8.70	3 39 226 101
140	199 038 004	199 038 017	199 038 185	199 038 164	1	10.60	3 39 226 101
160	199 038 005	199 038 018	199 038 186	199 038 165	1	12.30	3 39 226 101
225	199 038 006	199 038 019	199 038 187	199 038 166	1	19.10	3 39 226 101
280	199 038 007	199 038 020	199 038 188	199 038 167	1	33.90	3 39 226 101
315	199 038 008	199 038 021	199 038 189	199 038 168	1	50.70	3 39 226 101

d (mm)	d3 (mm)	H (mm)	H1 (mm)	H2 (mm)	H3 (mm)	L (mm)	L1 (mm)	L2 (mm)	Cv value (Δp=1 psi) (l/min)
63	95	298	63	140	95	43	45	220	220
75	114	320	73	152	95	46	45	220	320
90	131	335	81	159	95	46	45	220	500
110	152	370	97	178	95	52	45	220	820
140	182	398	112	181	95	56	45	320	1300
160	209	420	122	203	95	56	45	320	1900
225	262	489	149	245	95	60	45	320	3330
280	331	573	203	275	48	68	63	560	5400
315	380	651	241	315	48	78	63	560	8000

The technical data are not binding. They neither constitute expressly warranted characteristics nor guaranteed properties nor a guaranteed durability. They are subject to modification. Our General Terms of Sale apply.

# Data sheet

valid from: 12/21/22

---



Georg Fischer Piping Systems Ltd, Postfach, CH-8201 Schaffhausen/Switzerland

Phone +41 -(0)52-631 1111

e-mail: [info.ps@georgfischer.com](mailto:info.ps@georgfischer.com)

Internet: <http://www.gfps.com>