



Lug-Style, end installation butterfly valve metal type 038
With hand lever
Flange standard metric - PN10
Disc: stainless steel DIN Norm 1.4408 without coating

Model:

- Lug Style
- Body GGG40 (A 395 / A395 M-99, EN-JIS 1020 EN1563) Rilsan® coating
- Body from DN350 Epoxy® coating
- Installation length: EN 558 row 20
- Interface according to DIN EN ISO 5211
- Pressure range: 16 bar (DN 50-300); 10 bar (DN 350-600)
- Single-piece axis with square profile, up to DN 600 mm 2-pieces axis
- Multiple flange connection: DIN PN 6/10/16; other standard e.g. ANSI/ASME B16.5 Class 150 on request

Option:

- Electric and pneumatic actuator on request
- Other liner material on request

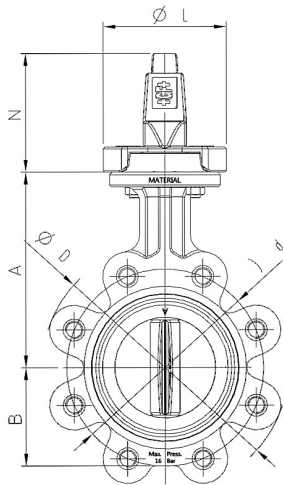

d (mm)	DN (mm)	Size (inch)	PN (bar)	Cv-value (l/min)	Sleeve: EPDM Code	PF	SP	weight (kg)
63	50	2	16	3140	199 038 200	3 39	226 101	1 3.90
75	65	2 ½	16	4570	199 038 201	3 39	226 101	1 5.00
90	80	3	16	7140	199 038 202	3 39	226 101	1 6.70
110	100	4	16	11710	199 038 203	3 39	226 101	1 8.80
140	125	5	16	18570	199 038 204	3 39	226 101	1 10.60
160	150	6	16	27130	199 038 205	3 39	226 101	1 12.30
225	200	8	16	47130	199 038 206	3 39	226 101	1 19.10
280	250	10	16	77110	199 038 207	3 39	226 101	1 33.90
315	300	12	16	114240	199 038 208	3 39	226 101	1 50.70

d (mm)	Sleeve: FKM Code	Sleeve: EPDM DVGW Code	Sleeve: NBR Code
63	199 038 213	199 038 191	199 038 169
75	199 038 214	199 038 192	199 038 170
90	199 038 215	199 038 193	199 038 171
110	199 038 216	199 038 194	199 038 172
140	199 038 217	199 038 195	199 038 173
160	199 038 218	199 038 196	199 038 174
225	199 038 219	199 038 197	199 038 175
280	199 038 220	199 038 198	199 038 176
315	199 038 221	199 038 199	199 038 177

d (mm)	d3 (mm)	H (mm)	H1 (mm)	L1 (mm)	H2 (mm)	H3 (mm)	L (mm)	L2 (mm)	Cv value (Δp=1 psi) (l/min)
63	95	298	63	45	140	95	43	220	220
75	114	320	73	45	152	95	46	220	320
90	131	335	81	45	159	95	46	220	500
110	152	370	97	45	178	95	52	220	820
140	182	398	112	45	181	95	56	320	1300
160	209	420	122	45	203	95	56	320	1900
225	262	489	149	45	245	95	60	320	3330
280	331	573	203	63	275	48	68	560	5400
315	380	651	241	63	315	48	78	560	8000

Data sheet

valid from: 11/24/23



The technical data are not binding. They neither constitute expressly warranted characteristics nor guaranteed properties nor a guaranteed durability. They are subject to modification. Our General Terms of Sale apply.

Georg Fischer Piping Systems Ltd, Postfach, CH-8201 Schaffhausen/Switzerland Phone +41 -(0)52-631 1111 e-mail: info.ps@georgfischer.com Internet: <http://www.gfps.com>