

## 654 - Blue clamp saddles with stainless steel reinforcing ring, flat gasket and galvanized bolts and nuts (PN16-PN10)

- bolts and nuts : galvanized
- colour: blue
- B= N° of bolts
- M= bolt type
- (\*) with O-ring gasket
- water PN16-10
- suitable for PE and PVC pipes
- female thread: ISO 7 (parallel)
- gasket: O-ring with flat lip (NBR)
- material: PP
- reinforcement ring: stainless steel AISI430

	d (mm)	Rp (inch)	PN (bar)	B	M	Code	SP	GP	weight (kg)
*	20	½	16	2	M8X40	158 001 041	1		0.118
*	25	½	16	2	M8X30	158 001 042	1		0.110
*	25	¾	16	2	M8X30	158 001 043	1		0.110
*	32	½	16	2	M8X30	158 001 044	1		0.103
*	32	¾	16	2	M8X30	158 001 045	1		0.115
*	32	1	16	2	M8X40	158 001 046	1		0.151
	40	½	16	2	M8X40	158 001 047	1		0.135
	40	¾	16	2	M8X40	158 001 048	1		0.137
	40	1	16	2	M8X40	158 001 049	1		0.141
	50	½	16	4	M8X40	158 001 050	1		0.195
	50	¾	16	4	M8X40	158 001 051	1		0.202
	50	1	16	4	M8X40	158 001 052	1		0.206
	50	1 ¼	16	4	M8X40	158 001 053	1		0.201
	63	½	16	4	M8X40	158 001 054	1		0.212
	63	¾	16	4	M8X40	158 001 055	1		0.222
	63	1	16	4	M8X40	158 001 056	1		0.228
	63	1 ¼	16	4	M8X40	158 001 058	1		0.262
	63	1 ½	16	4	M8X40	158 001 057	1		0.277
	75	½	16	4	M8X60	158 001 059	1		0.364
	75	¾	16	4	M8X60	158 001 060	1		0.369
	75	1	16	4	M8X60	158 001 061	1		0.384
	75	1 ¼	16	4	M8X60	158 001 063	1		0.421
	75	1 ½	16	4	M8X60	158 001 062	1		0.423
	75	2	16	4	M8X60	158 001 064	1		0.445
	90	½	16	4	M8X60	158 001 065	1		0.412
	90	¾	16	4	M8X60	158 001 066	1		0.421
	90	1	16	4	M8X60	158 001 067	1		0.432
	90	1 ¼	16	4	M8X60	158 001 069	1		0.472
	90	1 ½	16	4	M8X60	158 001 068	1		0.465
	90	2	16	4	M8X60	158 001 070	1		0.479
	110	½	16	6	M8X50	158 001 071	1		0.511
	110	¾	16	6	M8X50	158 001 072	1		0.509
	110	1	16	6	M8X50	158 001 073	1		0.518
	110	1 ¼	16	6	M8X50	158 001 075	1		0.565
	110	1 ½	16	6	M8X50	158 001 074	1		0.563
	110	2	16	6	M8X50	158 001 076	1		0.570
	110	3	6	6	M8x70	158 001 077	1		1.090
	125	½	16	6	M8X50	158 001 078	1		0.578
	125	¾	16	6	M8X50	158 001 079	1		0.590
	125	1	16	6	M8X50	158 001 080	1		0.592
	125	1 ¼	16	6	M8X50	158 001 082	1		0.612
	125	1 ½	16	6	M8X50	158 001 081	1		0.627
	125	2	16	6	M8X50	158 001 083	1		0.643
	125	3	6	6	M8X70	158 001 084	1		1.009
	125	4	6	6	M8X70	158 001 085	1		1.051
	140	½	16	6	M8X70	158 001 086	1		0.831

# Data sheet

valid from: 7/17/24

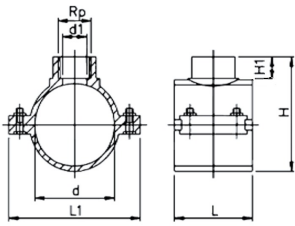

d (mm)	Rp (inch)	PN (bar)	B	M	Code	SP	GP	weight (kg)	
140	¾	16	6	M8X70	158 001 087	1		0.832	
140	1	16	6	M8X70	158 001 088	1		0.836	
140	1 ¼	16	6	M8X70	158 001 090	1		0.869	
140	1 ½	16	6	M8X70	158 001 089	1		0.858	
140	2	16	6	M8X70	158 001 091	1		0.883	
140	3	10	6	M8X70	158 001 092	1		1.091	
140	4	10	6	M8X70	158 001 093	1		1.123	
160	½	16	6	M8X70	158 001 094	1		0.896	
160	¾	16	6	M8X70	158 001 095	1		0.875	
160	1	16	6	M8X70	158 001 096	1		0.915	
160	1 ¼	16	6	M8X70	158 001 098	1		0.935	
160	1 ½	16	6	M8X70	158 001 097	1		0.933	
160	2	16	6	M8X70	158 001 099	1		1.021	
160	3	10	6	M8X70	158 001 100	1		1.013	
160	4	10	6	M8X70	158 001 101	1		1.262	
*	180	1	10	6	M10X80	158 001 102	1		1.954
*	180	1 ½	10	6	M10X80	158 001 103	1		1.978
*	180	1 ¼	10	6	M10X80	158 001 104	1		1.980
*	180	2	10	6	M10X80	158 001 105	1		1.995
*	180	3	10	6	M10X80	158 001 106	1		2.004
*	180	4	10	6	M10X80	158 001 107	1		2.059
*	200	1 ½	10	6	M10X80	158 001 108	1		1.927
*	200	2	10	6	M10X80	158 001 109	1		1.948
*	200	3	10	6	M10X80	158 001 110	1		1.980
*	200	4	10	6	M10X80	158 001 111	1		2.020
*	225	1 ½	10	6	M10X80	158 001 112	1		2.034
*	225	2	10	6	M10X80	158 001 113	1		2.050
*	225	3	10	6	M10X80	158 001 114	1		2.115
*	225	4	10	6	M10X80	158 001 115	1		2.167
*	250	2	10	6	M10X80	158 001 116	1		2.431
*	250	3	10	6	M10X80	158 001 117	1		2.383
*	250	4	10	6	M10X80	158 001 118	1		2.428
	280	2	10	6	M10X160	158 001 119	1		3.448
*	280	3	10	6	M10X160	158 001 120	1		3.543
*	280	4	10	6	M10X160	158 001 121	1		3.585
	315	2	10	6	M10X110	158 001 122	1		4.096
*	315	3	10	6	M10X110	158 001 123	1		4.267
*	315	4	10	6	M10X110	158 001 124	1		4.259

d (mm)	Rp (inch)	d1 (mm)	L (mm)	L1 (mm)	H (mm)	H1 (mm)	
*	20	½	12	46	77	59	26
*	25	½	13	49	79	58	15
*	25	¾	13	49	79	58	15
*	32	½	14	49	79	62	20
*	32	¾	14	49	79	62	20
*	32	1	14	62	87	70	20
	40	½	21	62	86	71	20
	40	¾	21	62	86	71	20
	40	1	21	62	86	70	19
	50	½	21	62	86	82	20
	50	¾	21	62	86	82	20
	50	1	21	62	86	82	20
	50	1 ¼	21	62	86	82	20
	63	½	18	62	101	96	21
	63	¾	24	62	101	96	21
	63	1	31	62	101	96	21
	63	1 ¼	31	62	101	96	21
	63	1 ½	31	62	101	96	21

# Data sheet

valid from: 7/17/24

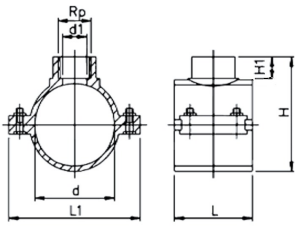

	d	Rp	d1	L	L1	H	H1
	(mm)	(inch)	(mm)	(mm)	(mm)	(mm)	(mm)
	75	½	16	79	123	102	14
	75	¾	21	79	123	104	16
	75	1	27	79	123	107	19
	75	1 ¼	35	79	123	109	21
	75	1 ½	42	79	123	109	21
	75	2	53	79	123	112	24
	90	½	16	87	138	116	14
	90	¾	21	87	138	118	16
	90	1	27	87	138	121	19
	90	1 ¼	35	87	138	123	21
	90	1 ½	42	87	138	123	21
	90	2	53	87	138	126	24
	110	½	15	99	152	150	23
	110	¾	20	99	152	150	23
	110	1	26	99	152	150	23
	110	1 ¼	35	99	152	150	23
	110	1 ½	41	99	152	150	23
	110	2	51	99	152	150	23
	110	3	85	99	152	150	23
	125	½	15	101	166	169	24
	125	¾	20	101	166	169	24
	125	1	26	101	166	169	24
	125	1 ¼	35	101	166	168	23
	125	1 ½	41	101	166	168	23
	125	2	50	101	166	168	23
	125	3	85	139	178	180	37
	125	4	90	139	178	181	38
	140	½	18	114	207	191	25
	140	¾	24	114	207	191	25
	140	1	30	114	207	191	25
	140	1 ¼	38	114	207	191	25
	140	1 ½	45	114	207	191	24
	140	2	50	114	207	191	24
	140	3	85	142	208	201	38
	140	4	90	142	208	201	38
	160	½	18	114	226	215	24
	160	¾	24	114	226	215	24
	160	1	30	114	226	215	24
	160	1 ¼	37	114	226	215	24
	160	1 ½	45	114	226	215	24
	160	2	51	114	226	215	24
	160	3	84	142	228	222	38
	160	4	90	142	228	222	38
*	180	1	30	169	262	265	38
*	180	1 ½	54	169	262	265	38
*	180	1 ¼	36	169	262	265	38
*	180	2	54	169	262	265	38
*	180	3	85	169	262	265	38
*	180	4	103	169	262	267	40
*	200	1 ½	45	169	262	265	38
*	200	2	54	169	262	265	38
*	200	3	85	169	262	265	38
*	200	4	103	169	262	267	40
*	225	1 ½	45	174	287	287	26
*	225	2	51	174	287	287	26
*	225	3	85	174	287	295	37
*	225	4	103	174	287	295	38
*	250	2	55	178	310	314	38
*	250	3	85	178	310	314	38

# Data sheet

valid from: 7/17/24

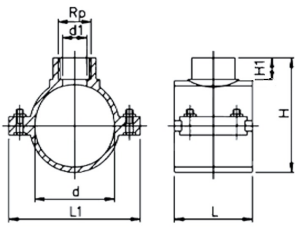

	<b>d</b>	<b>Rp</b>	<b>d1</b>	<b>L</b>	<b>L1</b>	<b>H</b>	<b>H1</b>
	(mm)	(inch)	(mm)	(mm)	(mm)	(mm)	(mm)
*	250	4	103	178	310	314	38
	280	2	51	179	335	326	31
*	280	3	78	179	335	338	41
*	280	4	98	179	335	338	46
	315	2	51	246	390	350	31
*	315	3	78	246	390	363	41
*	315	4	98	246	390	363	46

The technical data are not binding. They neither constitute expressly warranted characteristics nor guaranteed properties nor a guaranteed durability. They are subject to modification. Our General Terms of Sale apply.

Georg Fischer Piping Systems Ltd, Postfach, CH-8201 Schaffhausen/Switzerland Phone +41 -(0)52-631 1111 e-mail: info.ps@georgfischer.com Internet: <http://www.gfps.com>