

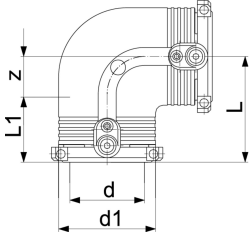

ELGEF Plus Elbow 90° PE100
d20-63mm / SDR11

- PE 100 SDR 11 (ISO S5)
- PE100 SDR11, metric
- 4mm pin connectors
- Limited path fusion indicators



d (mm)	Code	weight (kg)	d1 (mm)	L (mm)	L1 (mm)	z (mm)	SDR pipe
20	753 101 606	0.080	35	54	34	20	9-11
25	753 101 607	0.074	35	54	34	20	9-11
32	753 101 608	0.094	44	53	36	17	9-11
40	753 101 609	0.128	54	62	39	23	9-11
50	753 101 610	0.196	66	71	43	28	9-11
63	753 101 611	0.312	81	81	48	32	9-17.6

The technical data are not binding. They neither constitute expressly warranted characteristics nor guaranteed properties nor a guaranteed durability. They are subject to modification. Our General Terms of Sale apply.

Georg Fischer Piping Systems Ltd, Postfach, CH-8201 Schaffhausen/Switzerland Phone +41 -(0)52-631 1111 e-mail: info.ps@georgfischer.com Internet: <http://www.gfps.com>