

## INSTAFLEX Valve BTV 2 PB

Electro fusion quality for portable water  
 Gasket: EPDM, approved for potable hot and cold water  
 Brass: UBA conform

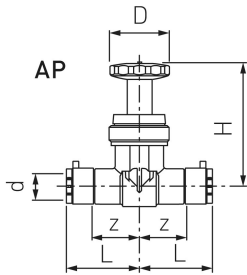

d (mm)	DN (mm)	Code	SP	weight (kg)	D (mm)	L (mm)	H (mm)	z (mm)
20	15	<b>761 069 647</b>	1	0.425	55	86	112	47
25	20	<b>761 069 648</b>	1	0.427	55	89	112	47
32	25	<b>761 069 649</b>	1	0.470	55	94	112	52
40	32	<b>761 069 650</b>	1	1.237	90	112	165	65
50	40	<b>761 069 651</b>	1	1.369	90	120	165	71
63	50	<b>761 069 652</b>	1	1.851	90	141	165	90

The technical data are not binding. They neither constitute expressly warranted characteristics nor guaranteed properties nor a guaranteed durability. They are subject to modification. Our General Terms of Sale apply.

Georg Fischer Piping Systems Ltd, Postfach, CH-8201 Schaffhausen/Switzerland Phone +41 -(0)52-631 1111 e-mail:  
 info.ps@georgfischer.com Internet: <http://www.gfps.com>